

[Cabinet Outlet Depot](#) stocks more than 45 different kinds of cabinets, each in a choice of three styles. All are ready for immediate pickup at cash-and-carry pricing. This document provides a detailed description of the in-stock cabinets for your reference.

All cabinets are available in your choice of three styles: Salem Solid Natural Maple, Manchester Textured White Thermofoil, and Contempra Natural Maple Melamine. Many other styles are available on a custom ordering basis.

Salem
Solid Natural Maple



Manchester
Textured White Thermofoil



Contempra
Natural Maple Melamine



It's hard to choose a cabinet style over the internet. We suggest that you visit our showroom in Mississauga Ontario to see the three styles above in real sample kitchens...so that your final choice is the best choice for your project.

Cabinets are specified with stock number and desired style.

Copyright © 2009, Cabinet Outlet Depot, cabinetoutletdepot.com telephone 905-625-0263
1825 Dundas Street East (enter off Wharton Way), Mississauga, Ontario, Canada L4X 2X1

The following diagrams illustrate the [Cabinet Outlet Depot](http://CabinetOutletDepot.com) in-stock cabinets. Other cabinets are available on a custom ordering basis. Cabinets are fully assembled, and are both doweled and glued for the strongest structure. Cabinets are supplied without hardware (knobs, handles, pulls), which are ordered and installed separately.

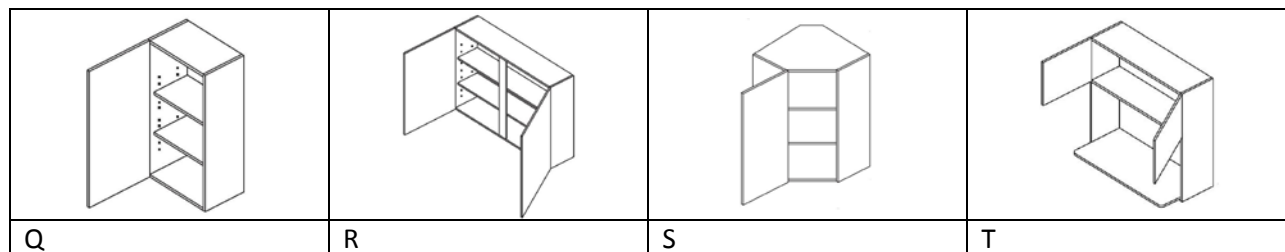
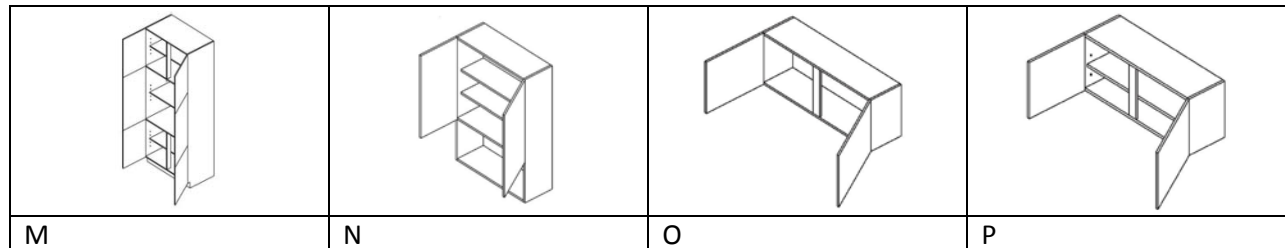
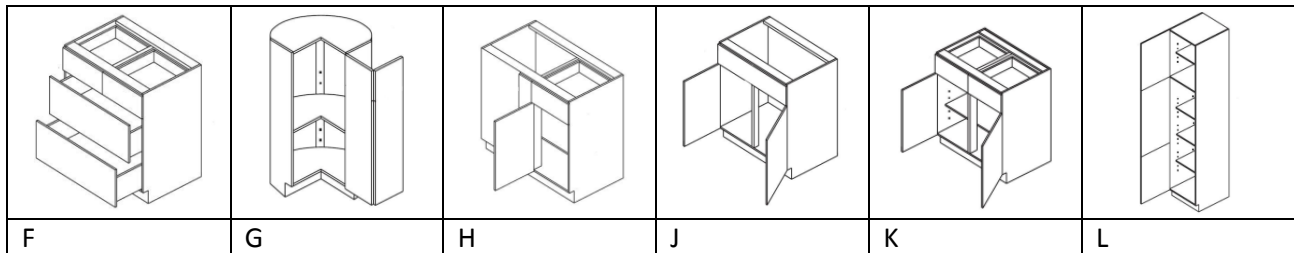
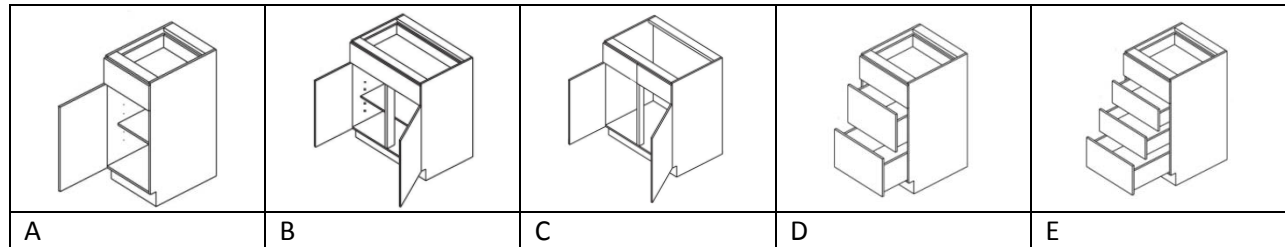

Cabinets are listed on the following pages in several categories. Each listing has the stock number, a key to the cabinet diagram above, dimensions, and a text description.

Cabinets are specified with stock number and desired style.

BASE CABINETS

Stock Number	Diagram	Depth	Width	Height	Description
B9	A	24"	9"	34 5/8"	1 door, top drawer, adjustable interior shelf
B12	A	24"	12"	34 5/8"	1 door, top drawer, adjustable interior shelf
B15	A	24"	15"	34 5/8"	1 door, top drawer, adjustable interior shelf
B18	A	24"	18"	34 5/8"	1 door, top drawer, adjustable interior shelf
B21	A	24"	21"	34 5/8"	1 door, top drawer, adjustable interior shelf
B24-2	B	24"	24"	34 5/8"	2 doors, full width top drawer, adjustable interior shelf
B27	K	24"	27"	34 5/8"	2 doors, 2 top drawers, adjustable interior shelf
B30	K	24"	30"	34 5/8"	2 doors, 2 top drawers, adjustable interior shelf
B33	K	24"	33"	34 5/8"	2 doors, 2 top drawers, adjustable interior shelf
B36	K	24"	36"	34 5/8"	2 doors, 2 top drawers, adjustable interior shelf
BD153V	D	24"	15"	34 5/8"	1 standard top drawer, 2 deep drawers below
BD184V	E	24"	18"	34 5/8"	3 equal top drawers, 1 deep bottom drawer
BD304S	F	24"	30"	34 5/8"	2 top drawers, 2 full width deep bottom drawers
BCC33FH	G	24"	33"	34 5/8"	base corner cabinet, installed 33" from each wall

BASE CABINETS for sink

Stock Number	Diagram	Depth	Width	Height	Description
BS24-2	J	24"	24"	34 5/8"	2 doors, 1 false front (no drawer), no interior shelf
BS33	C	24"	33"	34 5/8"	2 doors, 2 false fronts (no drawers), no interior shelf
BS36	C	24"	36"	34 5/8"	2 doors, 2 false fronts (no drawers), no interior shelf

TALL CABINETS

Stock Number	Diagram	Depth	Width	Height	Description
T182484	L	24"	18"	84"	doors and shelves as in diagram
242484-2	M	24"	24"	84"	doors and shelves as in diagram
T302484	M	24"	30"	84"	doors and shelves as in diagram

Cabinets are specified with stock number and desired style.

WALL CABINETS

Stock Number	Diagram	Depth	Width	Height	Description
W3015	O	11 3/4"	30"	15"	2 doors
W3315	O	11 3/4"	33"	15"	2 doors
W3615	O	11 3/4"	36"	15"	2 doors
W331524	O	24"	33"	15"	2 doors, extra deep
W2418-2	O	11 3/4"	24"	18"	2 doors
W3018	O	11 3/4"	30"	18"	2 doors
W3318	O	11 3/4"	33"	18"	2 doors
W3324	P	11 3/4"	33"	24"	2 doors, adjustable interior shelf
W3624	P	11 3/4"	36"	24"	2 doors, adjustable interior shelf
W930	Q	11 3/4"	9"	30"	1 door, 2 adjustable interior shelves
W1230	Q	11 3/4"	12"	30"	1 door, 2 adjustable interior shelves
W1530	Q	11 3/4"	15"	30"	1 door, 2 adjustable interior shelves
W1830	Q	11 3/4"	18"	30"	1 door, 2 adjustable interior shelves
W2130	Q	11 3/4"	21"	30"	1 door, 2 adjustable interior shelves
W2430-2	R	11 3/4"	24"	30"	2 doors, 2 adjustable interior shelves
W2730	R	11 3/4"	27"	30"	2 doors, 2 adjustable interior shelves
W3030	R	11 3/4"	30"	30"	2 doors, 2 adjustable interior shelves
W3330	R	11 3/4"	33"	33"	2 doors, 2 adjustable interior shelves
W3630	R	11 3/4"	36"	36"	2 doors, 2 adjustable interior shelves
WM2736	T	11 3/4"	27"	36"	microwave shelf cabinet
WA2430	S	11 3/4"	24"	30"	corner with 1 door, 2 interior adjustable shelves

VANITY CABINETS

Stock Number	Diagram	Depth	Width	Height	Description
VS24-2	J	21"	24"	31 5/8"	2 doors, 1 top false front, no shelves
VS30	C	21"	30"	31 5/8"	2 doors, 2 top false fronts. no shelves
VS36	C	21"	36"	31 5/8"	2 doors, 2 top false fronts, no shelves
VD123V	D	21"	12"	31 5/8"	1 top drawer, 2 deep bottom drawers
VD153V	D	21"	15"	31 5/8"	1 top drawer, 2 deep bottom drawers
VW2433-2	N	7 1/2"	24"	33"	wall unit, 2 doors on top, 3 interior shelves

(document revision 5)

Cabinets are specified with stock number and desired style.

Copyright © 2009, Cabinet Outlet Depot, cabinetoutletdepot.com telephone 905-625-0263
1825 Dundas Street East (enter off Wharton Way), Mississauga, Ontario, Canada L4X 2X1